

INSET A - TERMINAL SIGNS AND GATEWAY FEATURE - SCALE 1:250m

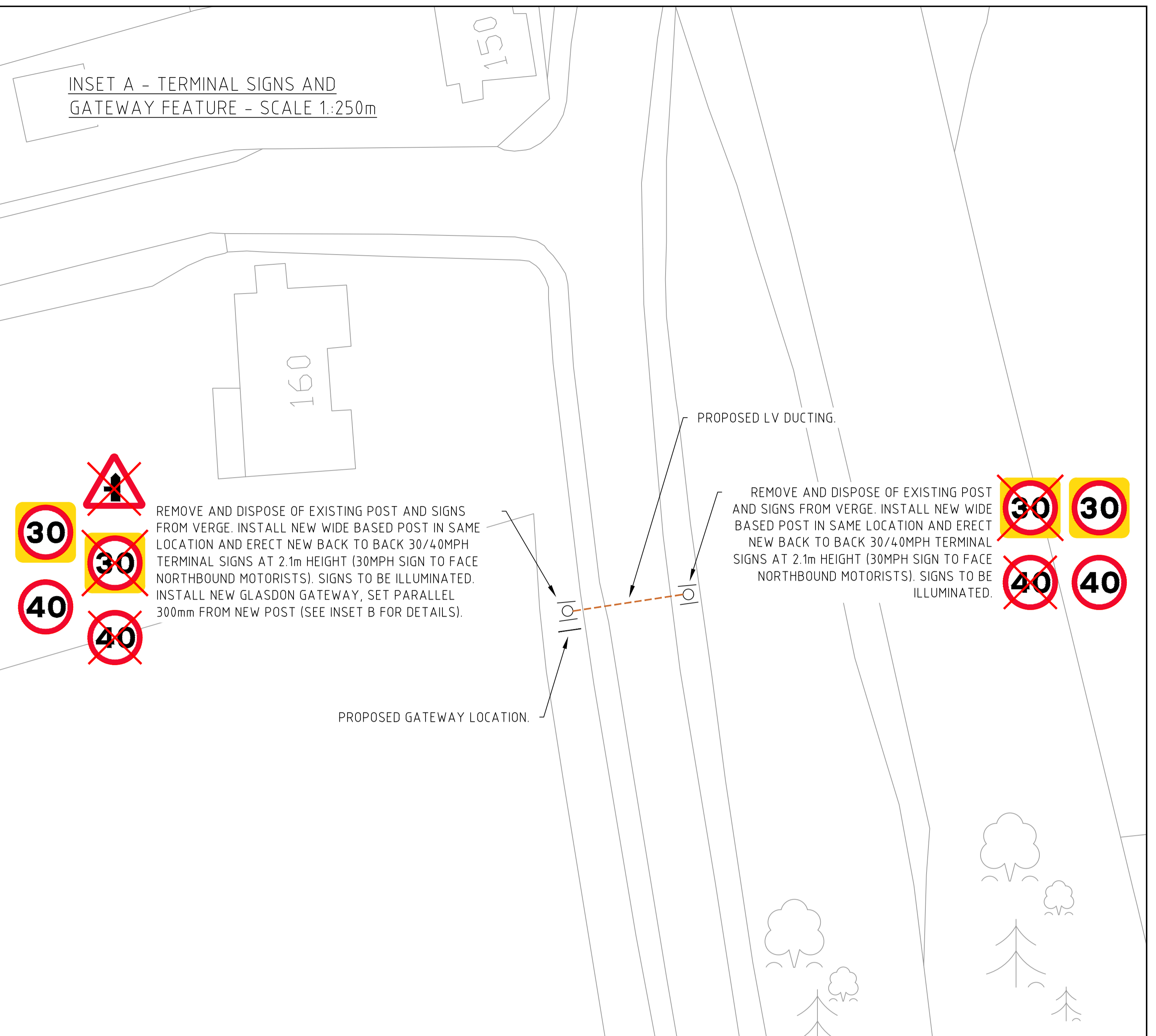

30/40mph TERMINAL SIGNS TO EXISTING PEDESTRIAN CROSSING - PROPOSED ROAD MARKING AMENDMENTS INTENDED TO ENCOURAGED REDUCED VEHICLE SPEEDS - DETAILS TO BE CONFIRMED, BUT ANTICIPATED TO INCLUDE CENTRAL HATCHING AND EDGE OF CARRIAGEWAY LINING/HATCHING TO CREATE HORIZONTAL DEFLECTION

INSET B - GATEWAY FEATURE

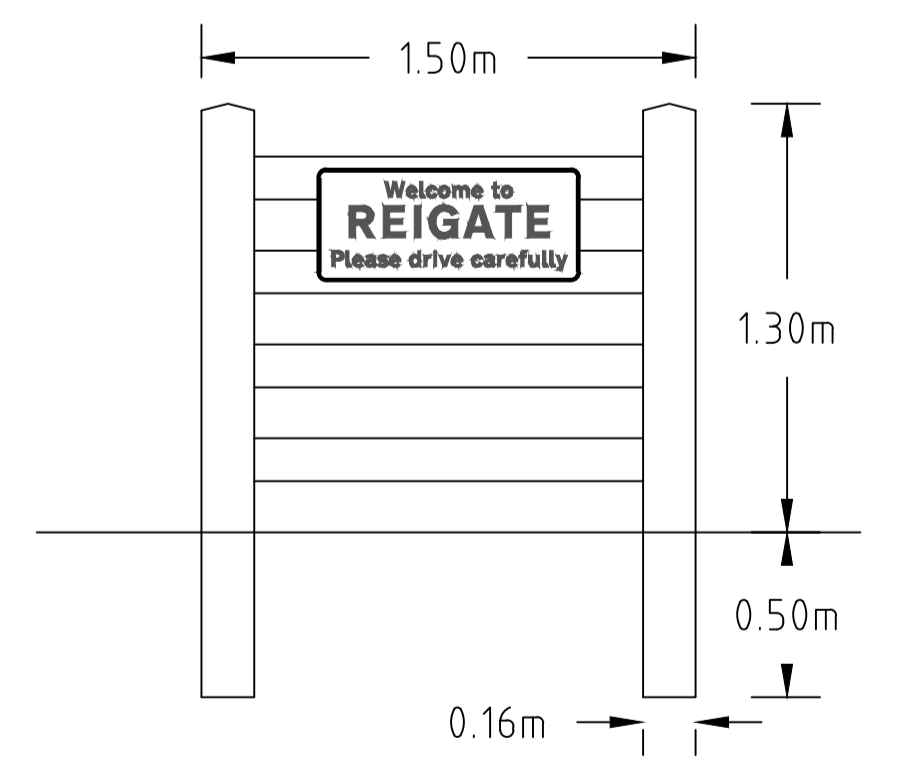

Scheme Ref.		x-height	
Sign Ref.	2402.1	70.0	
Letter colour	BLACK	SIGN FACE	
Background	WHITE	Width	795mm
Border	BLACK	Height	340mm
Material	Class RA2 (12899-1:2007)	Area	0.27sq.m



Scheme Ref.		x-height	
Sign Ref.	670-30	100.0	
Letter colour	N/A	SIGN FACE	
Background	YELLOW	Width	660mm
Border	N/A	Height	660mm
Material	Class RA2 (12899-1:2007)	Area	0.44m ²



Sign Reference	670-40
Height	600mm
Width	600mm
Area	0.28 m ²
Material	Class RA2 (12899-1:2007)
Mount Height	2400

Notes

Rev.	Description	Drwn	Sig.	Date	Chkd	Sig.	Date	Appr	Sig.	Date

North Point	Drawn by	Sig.	Date	Checked by	Sig.	Date	Approved by	Sig.	Date
	SP	SP	AUG 17	SP	SP	AUG 17	JD	JD	AUG 17
	SP	SP	AUG 17	SP	SP	AUG 17	JD	JD	AUG 17
	JD	JD	AUG 17	JD	JD	AUG 17	JD	JD	AUG 17

Scale VARIES - AS SHOWN

Based upon the Ordnance Survey mapping with the permission of the Controller of Her Majesty's Stationery Office. Crown copyright. Unauthorised reproduction infringes Crown copyright and may lead to prosecution or civil proceedings. Surrey County Council LA 076872 2002.

Project A217 REIGATE TO HORLEY (WHOLE ROUTE STUDY)
SITE No. 7 - A217 DOVERS GREEN ROAD, REIGATE

Drawing GENERAL ARRANGEMENT

SHEET 1 OF 1

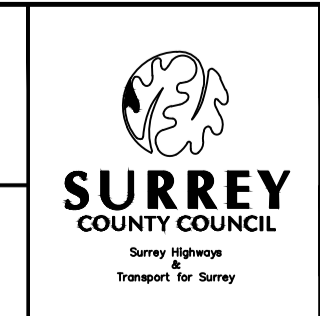

Project No.	SP0028
Contract Sheet No.	07-001
Rev.	-
Classification	DRAFT

This page is intentionally left blank